

TOP VIEW

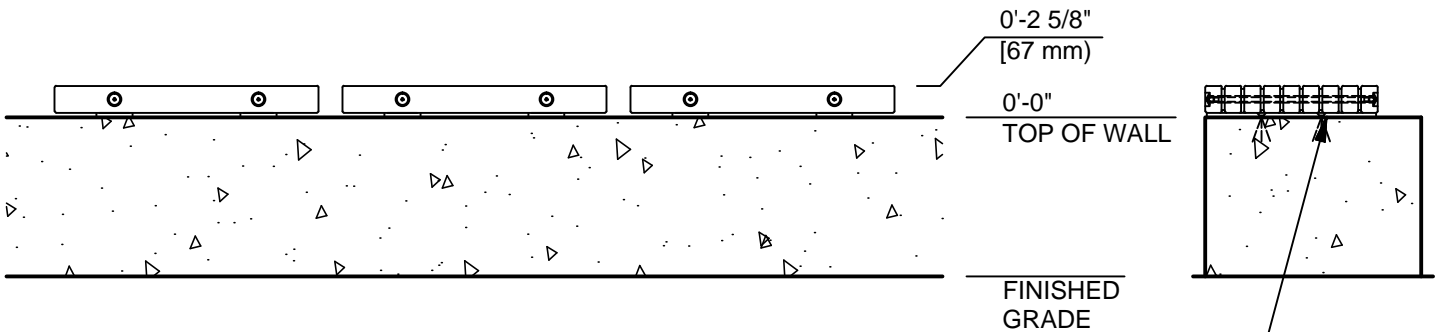

NOTE:
 CONCRETE WALL AND ANCHORS (BY OTHERS)
 PER LOCAL CONDITIONS. CONSULT PROJECT
 ENGINEER FOR EXACT REQUIREMENTS.

3/8" DIA. (10 mm) HOLE
 WITH COUNTERSINK IN WALL-TOP
 SEAT FRAMES FOR ANCHORING
 DEVICES BY OTHERS (TYPICAL-12,
 TWO PER FRAME).

FRONT VIEW

END VIEW

Date	Revision	By
△		
△		
△		
△		
Scale 3/4"=1'-0"	Drawn by: DW 01-30-17	Ck'd by: CL 01-30-17

COLUMBIA CASCADE COMPANY
 Makers of TimberForm®, PipeLine®, RePlay®,
 TimberForm®-2 and CycLoops® Products.

1300 S.W. Sixth Avenue, Suite 310
 Portland, Oregon 97201-3464
 U.S.A.

Telephone 503/223-1157
 Facsimile 503/223-4530

This drawing reveals the copyrighted intellectual property of Columbia Cascade Company. Not for use by others without our express, written authorization.

Title: TIMBERFORM PARKWAY MODEL NO. 2047-2-01 WALL TOP SEATS	
Drawing No. W-2047-2-01	Sheet 1 of 1